

# A18

1989



### Lampholder:

Rated voltage:  
 Impulse voltage:  
 Rated current:  
 Working temperature:  
 Connected cables  
 working temperature:  
 Overvoltage category:  
 Protection degree (IP):  
 In conformity to the standards:  
 In conformity to the requirements  
 of the directive:

**RX7s**  
  
**500 V**  
**5 kV**  
**6 A**  
**T 260°C**  
  
**T 105°÷ 250°C**  
**III**  
**IP20**  
**EN 60838-1 \***  
  
**2014/35/EU**

Approval marks:

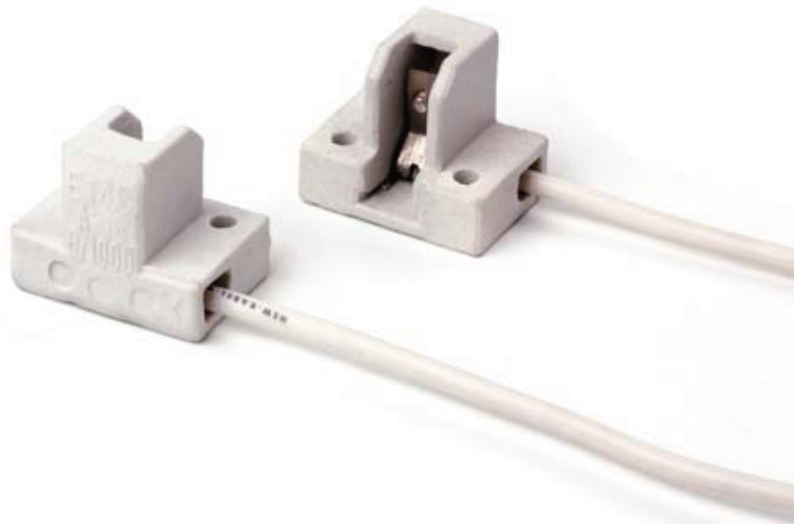

Single-conductor, flexible connecting cables crimped to the lampholder:

Insulation	T in °C	Conduct.	Available sections and tensions			
			Pulse kV	0,75 mm <sup>2</sup>	1,00 mm <sup>2</sup>	1,50 mm <sup>2</sup>
Oversize silicone <i>Single insulation</i>	180	CuSn	10kV		•	
Oversize silicone <i>Single insulation</i>	180	CuSn	5kV	•	•	
Silicone+Silicone <i>Single insulation</i>	180	CuSn	5kV	•	•	
Oversize PTFE <i>Single insulation</i>	250	CuNi	5kV		•	
Oversize PTFE +PFA <i>Double insulation</i>	250	CuNi	5kV		•	

\* The article complies with all the requirements of standard EN 60838-1 26 with exception to the prescription regarding the lamp insertion, which in the standard EN 60061-2, data sheet 7005-53-3, is required to be maximum 45N, while in this lampholder is 50N.

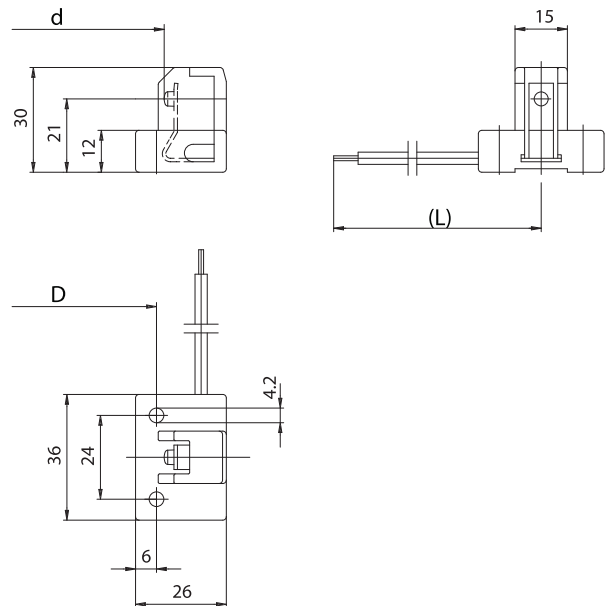

# LAMPHOLDERS FOR DISCHARGE LAMPS

**Note: the pair is composed by one lampholder with cable exit from the right side and the other with cable exit from the left side.**

- Porcelain body.  
Contacts in nickel-plated electrolytic copper.  
Pressure springs in hardened and normalized steel.
- Weight of the lampholders pair in standard execution (with cables L = 25 cm): 70 g.
- D: fixing distance of the lampholders pair on rigid structures:
  - 104,0 mm for lamps with RX7s cap, with "Z nom." lamp 114,2 mm (70W)
  - 121,8 mm for lamps with RX7s cap, with "Z nom." lamp 132,0 mm (150W)
- d: distance between the contacts = D + 6,6 mm
- Instructions to fix the lampholder on structures.

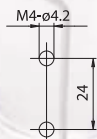

- Fixing of the lampholders pair by M4 screws to be inserted in the fixing holes with center distance 24 mm.

