

# A35

1989



### Lampholder:

Rated voltage:  
 Impulse voltage:  
 Rated current:  
 Working temperature:  
 Connected cables  
 working temperature:  
 Overvoltage category:  
 Protection degree (IP):  
 In conformity to the standards:  
 In conformity to the requirements  
 of the directive:

**Fc2**  
  
**500 V**  
**5 kV**  
**8 A**  
**T 250°C**  
  
**T 105°÷ 250°C**  
**III**  
**IP20**  
**EN 60838-1**  
  
**2014/35/EU**

Approval marks:



Single-conductor, flexible connecting cables crimped to the lampholder:

Insulation	T in °C	Conduct.	Available sections and tensions			
			Pulse kV	0,75 mm <sup>2</sup>	1,00 mm <sup>2</sup>	1,50 mm <sup>2</sup>
Oversize silicone <i>Single insulation</i>	180	CuSn	10kV		•	•
Oversize silicone <i>Single insulation</i>	180	CuSn	5kV	•	•	•
Silicone+Silicone <i>Single insulation</i>	180	CuSn	5kV	•	•	•
Oversize PTFE <i>Single insulation</i>	250	CuNi	5kV		•	•
Oversize PTFE +PFA <i>Double insulation</i>	250	CuNi	5kV		•	•

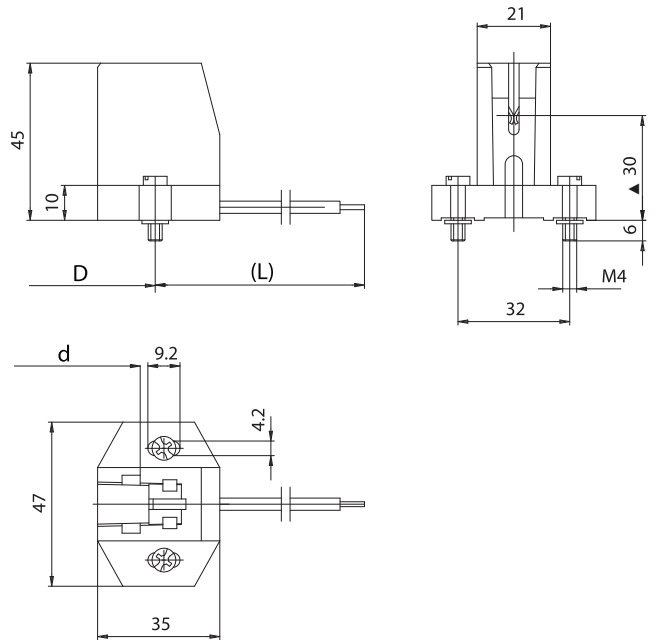

▲ Focus point of the lamp



# LAMPHOLDERS FOR DISCHARGE LAMPS

## **Current carrying capacity of cables:**

- 6A for cables of section until 0,75 mm<sup>2</sup>
- 8A for cables of section from 1,00 mm<sup>2</sup>

**Attention: the lampholders must be assembled on the proper fixing structures, so that, one lampholder is fixed and the other is movable. For this reason the screws of the fixed lampholder are white zinc-plated and completely threaded, and the screws of the movable lampholder are yellow zinc-plated and partially threaded.**

- Porcelain body.  
Contacts in special alloy.  
Pressure springs of the contacts in normalized stainless steel.  
Fixing screws already inserted in the lampholder.
- Weight of the lampholder in standard execution  
(with cables L = 25 cm): 155 g.
- D: fixing distance of the lampholders pair on rigid structures  
(dimension from the center of the slot):
  - 150,0 mm for lamps with Fc2 cap, with "Z nom." lamp  
139,0 mm (250W)
  - 193,0 mm for lamps with Fc2 cap, with "Z nom." lamp  
182,0 mm (400W)
  - 244,0 mm for lamps with Fc2 cap, with "Z nom." lamp  
233,0 mm (1000W)
- Instructions to fix the lampholder on structures.

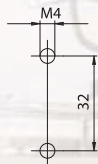

- Fixing of the lampholders pair by M4 screws slot + cross head already inserted in the lampholder body at center distance 32 mm.

