

# LAMPHOLDERS FOR DISCHARGE LAMPS

## A84



|                                       |  |
|---------------------------------------|--|
| <b>Lampholder:</b>                    | <b>GU8.5</b>                             |
| Rated voltage:                        | <b>500 V</b>                             |
| Rated current:                        | <b>4 A</b>                               |
| Impulse voltage:                      | <b>5 kV</b>                              |
| Working temperature:                  | <b>T 240°C</b>                           |
| Type of clamps to connect the cables: | <b>SPRING CLAMPS (push-in insertion)</b> |
| Clamps connecting capacity:           | <b>18 AWG</b>                            |
| In conformity to the standards:       | <b>UL 496<br/>CSA 22.2 N.43</b>          |
| Approval marks:                       | <b>cURus</b>                             |

- Steatite body.  
Insulating base in black LCP.  
Contacts in special silver-plated alloy.  
Springs for the positioning of the contacts in stainless steel.  
Push-in clamps built in the contacts.

- Weight: 25 g.

- Instruction to fix the lampholder on structures.

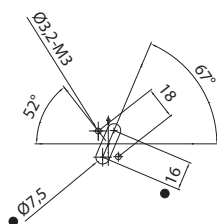

● Holes for cables passage (if necessary)

- Fixing of the lampholder:
  - with two M3 screws to be inserted in the fixing holes with center distance 18 mm;
  - using the fixing plate presented in the following pages.

Single-conductor flexible connecting cables which could be connected to the lampholder (arranged with crimped end-terminals):

| Insulation                                       | T in °C | Conduct. | Available voltages and AWG |       |
|--|---------|----------|----------------------------|-------|
|  |         |          | 600V                       | 18AWG |
| Silicone<br><i>Single insulation</i>             | 200     | CuSn     | •                          | •     |
| Silicone+glass-braid<br><i>Single insulation</i> | 200     | CuSn     | •                          | •     |
| PTFE<br><i>Single insulation</i>                 | 250     | CuNi     | •                          | •     |
| PTFE+PFA<br><i>Double insulation</i>             | 250     | CuNi     | •                          | •     |

Attention: in the end product the cables connected to this lampholder should not be accessible during the normal replacement operations of the lamp (if accessible a cord-grip device should be provided).



# A84

2010



### Lampholder:

Rated voltage:  
 Impulse voltage:  
 Rated current:  
 Working temperature:  
 Type of clamps to connect the cables:

**GU8.5**

**500 V**  
**5 kV**  
**4 A**  
**T 250°C**

Clamps connecting capacity:  
 Overvoltage category:  
 Protection degree (IP):  
 In conformity to the standards:  
 In conformity to the requirements of the directive:

**SPRING CLAMPS (push-in insertion)**

**0,75 - 1,00 mm**  
**III**  
**IP20**  
**EN 60838-1**

**2014/35/EU**

Approval marks:



Single-conductor flexible connecting cables which could be connected to the lampholder (arranged with crimped end-terminals):

| Insulation                                    | T in °C | Conduct. | Available sections and tensions |                      |                      |                      |
|---|---------|----------|---------------------------------|----------------------|----------------------|----------------------|
|   |         |          | Pulse kV                        | 0,75 mm <sup>2</sup> | 1,00 mm <sup>2</sup> | 1,50 mm <sup>2</sup> |
| Silicone+Silicone<br><i>Single insulation</i> | 180     | CuSn     | 5kV                             | •                    | •                    |                      |
| Oversize silicone<br><i>Single insulation</i> | 180     | CuSn     | 5kV                             | •                    | •                    |                      |
| Oversize PTFE<br><i>Single insulation</i>     | 250     | CuNi     | 5kV                             |                      | •                    |                      |
| Oversize PTFE+PFA<br><i>Double insulation</i> | 250     | CuNi     | 5kV                             |                      | •                    |                      |

On customer's request, the cable not subjected to the lamp starter voltage, can be supplied with basic insulation.

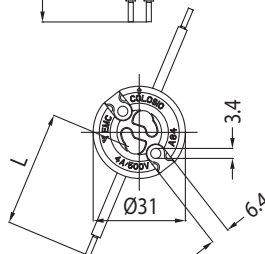
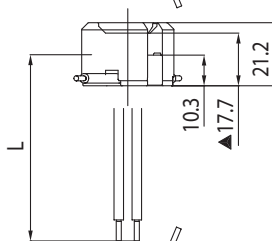
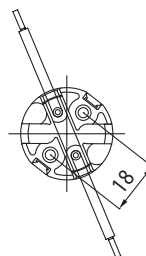

▲ Reference plane

