

# LAMPHOLDERS FOR DISCHARGE LAMPS

## A84A



Lampholder whose creepage and clearance distances allow the use in class II fixtures with pulse peak voltage up to 4kV, with working voltage up to 300V, and in applications foreseen for the overvoltage category III, if connected with double or triple insulated cables (ref. standard EN 60598.1).

- Steatite body.  
Insulating base in black LCP.  
Contacts in special silver-plated alloy.  
Springs for the positioning of the contacts in stainless steel.  
Push-in clamps built in the contacts.
- Weight: 25 g.

- Instruction to fix the lampholder on structures.

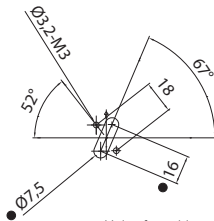

- Fixing of the lampholder:
  - with two M3 screws to be inserted in the fixing holes with center distance 18 mm;
  - using the fixing plate presented in the following pages.

<b>Lampholder:</b>	<b>GU8.5</b>
Rated voltage:	<b>500 V</b>
Rated current:	<b>4 A</b>
Impulse voltage:	<b>5 kV</b>
Working temperature:	<b>T 240°C</b>
Type of clamps to connect the cables:	<b>SPRING CLAMPS (push-in insertion)</b>
Clamps connecting capacity:	<b>18 AWG</b>
In conformity to the standards:	<b>UL 496</b> <b>CSA 22.2 N.43</b>
Approval marks:	<b>cURus</b>

Single-conductor flexible connecting cables which could be connected to the lampholder (arranged with crimped end-terminals):

Insulation	T in °C	Conduct.	Available voltages and AWG	
			600V	18AWG
Silicone <i>Single insulation</i>	200	CuSn	•	•
Silicone+glass-braid <i>Single insulation</i>	200	CuSn	•	•
PTFE <i>Single insulation</i>	250	CuNi	•	•
PTFE+PFA <i>Double insulation</i>	250	CuNi	•	•

Attention: in the end product the cables connected to this lampholder should not be accessible during the normal replacement operations of the lamp (if accessible a cord-grip device should be provided).



# A84A

2010



**Lampholder:**

Rated voltage:  
Impulse voltage:  
Rated current:  
Working temperature:  
Type of clamps to connect the cables:

**GU8.5**

**300 V**  
**4 kV**  
**4 A**  
**T 250°C**

**SPRING CLAMPS**  
**(push-in insertion)**

Clamps connecting capacity:  
Overvoltage category:  
Protection degree (IP):  
In conformity to the standards:  
In conformity to the requirements of the directive:

**0,75 - 1,00 mm**  
**III**  
**IP20**  
**EN 60838-1**

**2014/35/EU**

Approval marks:

**Double insulation**

Single-conductor flexible connecting cables which could be connected to the lampholder (arranged with crimped end-terminals):

Insulation	T in °C	Conduct.	Available sections and tensions			
			Pulse kV	0,75 mm <sup>2</sup>	1,00 mm <sup>2</sup>	1,50 mm <sup>2</sup>
Silicone+Silicone <i>Single insulation</i>	180	CuSn	5kV	•	•	
Oversize silicone <i>Single insulation</i>	180	CuSn	5kV	•	•	
Oversize PTFE <i>Single insulation</i>	250	CuNi	5kV		•	
Oversize PTFE+PFA <i>Double insulation</i>	250	CuNi	5kV		•	

On customer's request, the cable not subjected to the lamp starter voltage, can be supplied with basic insulation.

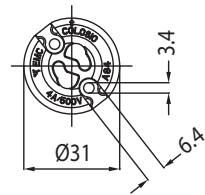
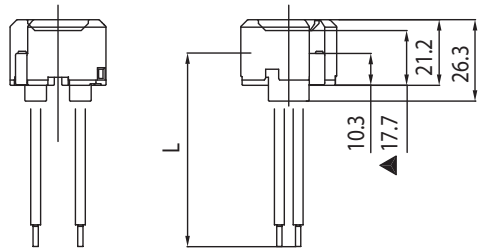
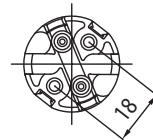

▲ Reference plane

