

# CONNECTING DEVICES

## M09

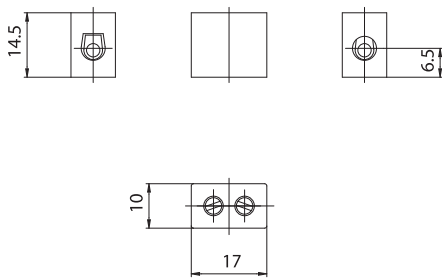

Type: **1 POLE CLAMP**  
 Rated voltage: **24 V**  
 Rated current: **8 A**  
 Working temperature: **T 300°C**  
 Type of clamps: **SCREW CLAMPS**  
 Clamps connecting capacity: **0,50 ÷ 1,50 mm<sup>2</sup>**

- Porcelain body.  
Brass bush clamps.  
Slot head screws in zinc-plated iron.

- Weight: 7 g.

*Note: to tighten the clamps screws, use a screwdriver with max. diameter 4 mm.*

## M10

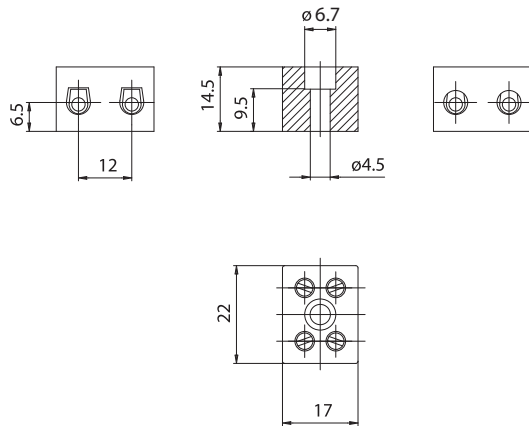

Type: **2 POLES CLAMP**  
 Rated voltage: **24 V**  
 Rated current: **8 A**  
 Working temperature: **T 300°C**  
 Type of clamps: **SCREW CLAMPS**  
 Clamps connecting capacity: **0,50 ÷ 1,50 mm<sup>2</sup>**

- Porcelain body.  
Brass bush clamps.  
Slot head screws in zinc-plated iron.

- Weight: 15 g.

*Note: to tighten the clamps screws, use a screwdriver with max. diameter 4 mm.*

- Eventual fixing by the central hole diameter 4,5 mm (if M4 screw is used, the head diameter has to be less than 6,5 mm).

