

# KNIFE SWITCHES - DISCONNECTING DEVICES

**M27B** 1990



Type: **2 POLES KNIFE SWITCH**

Rated voltage: **400 V**

Rated current: **16 A (10 A for M27BE)**

Resistance to surface currents: **TK 175**

Working temperature: **T 120°C**

Insulation class: **II**

Type of clamps to connect the cables: **SCREW CLAMPS**

Clamps connecting capacity: **1,50 ÷ 4,00 mm<sup>2</sup>**

Overvoltage category: **III**

Protection degree (IP): **IP20**

In conformity to the standards: **EN 60598-1**

In conformity to the requirements of the directive: **2014/35/EU**



Approval marks:

**M27B:** knife switch with rated current 16 A.  
**M27BE:** knife switch with rated current 10 A.  
**M27B-H:** knife switch as M27B or M27BE with black PPS body and with working temperature T220°C.

- Body in black thermoplastic material PA66 20% G.F. - V0. Contacts in nickel-plated phosphorous bronze. Bush-clamps with screws with combined slot+cross head, for cables section from 1,50 mm<sup>2</sup> to 4,00 mm<sup>2</sup>.

- Weight: 111 g.

*Note: to tighten the clamps screws, use a screwdriver with max. diameter 6 mm.*

- Instructions to fix the knife switch on structures.

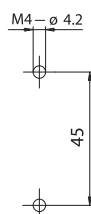

- Fixing of the knife switch using the holes diameter 4,2 mm with center distance 45 mm (if M4 screws are used, the head-diameter should be less than 7,5 mm).

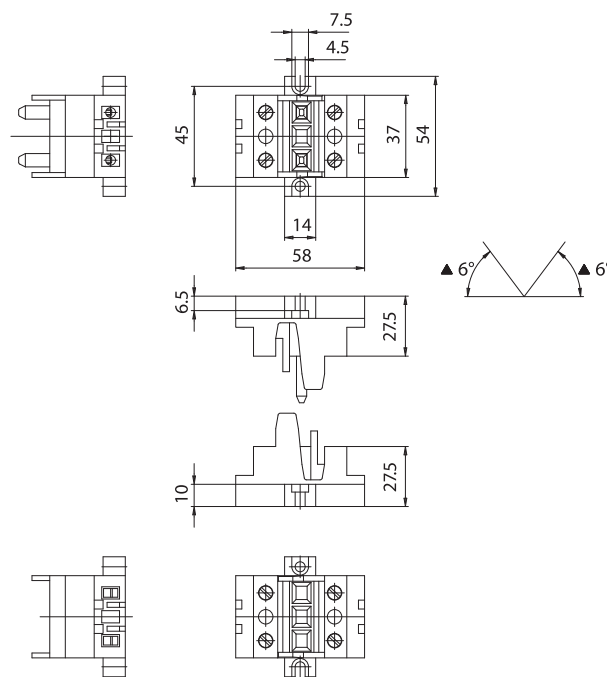

▲ Max. insertion angle

*Attention: the knife switch is provided to be used in internal wiring of lighting fixtures. It is not foreseen that an installer can connect this device to the net.*

