

# SWITCHES

## M85-

1998

## M95-



Switch:

M85-: **SWITCH + "EUROPEAN"  
BIPOLAR PLUG 2,5A**

M95-: **SWITCH**

Rated voltage:

**250 V**

Rated current:

**2 (1) A**

Insulation class:

**II**

Type of clamps for

cables connection:

**SCREW CLAMPS** (for art. M95-)

Clamps connecting capacity:

**0,75 mm<sup>2</sup>**

Protection degree:

**IP40**

In conformity to the standards:

**EN 50075-1**

In conformity to the requirements

of the directives:

**2014/35/EU**

Approval marks:

**IMQ**



- Table of the cables connectable to the switch:

Transparent switch version:

| Insulation               | Shape | Sections                 | Temperature             | Type   | cod./page            |
|--------------------------|-------|--------------------------|-------------------------|--------|----------------------|
| PVC + PVC<br>TRANSPARENT | flat  | 2 x 0,75 mm <sup>2</sup> | T70°C                   | FRDR   | RSP7T<br>(page 9057) |
| PVC + PVC<br>TRANSPARENT | flat  | 2 x 0,75 mm <sup>2</sup> | T70°C                   | FRDR   | RBP7T<br>(page 9056) |
| PVC + PVC<br>TRANSPARENT | round | 2 x 0,75 mm <sup>2</sup> | T70°C                   | FROR   | RS27T<br>(page 9057) |
| FEP + PVC<br>TRANSPARENT | flat  | 2 x 0,75 mm <sup>2</sup> | T70°C<br>(T180°C cores) | FR5FDR | BSP7T<br>(page 9063) |
| FEP + PVC<br>TRANSPARENT | round | 2 x 0,75 mm <sup>2</sup> | T70°C<br>(T180°C cores) | FR5FOR | BS27T<br>(page 9063) |

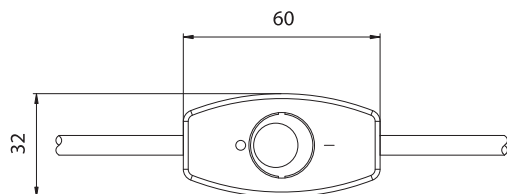

Coloured switch version:

| Insulation             | Shape | Sections                 | Temperature | Type       | cod./page            |
|------------------------|-------|--------------------------|-------------|------------|----------------------|
| PVC + PVC<br>N - B - O | flat  | 2 x 0,75 mm <sup>2</sup> | T70°C       | H03WH2-F   | RRP7-<br>(page 9053) |
| PVC + PVC<br>N - B - O | flat  | 2 x 0,75 mm <sup>2</sup> | T90°C       | H03V2ZH2-F | RHP7-<br>(page 9052) |

- Polycarbonate body, for the transparent version, PA66 body, for the coloured versions.  
Raw or nickel-plated phosphorous bronze or brass contacts.  
Brass clamps with slot screws (for art. M95-).  
PA66 cable-clamp (for art. M95-).

*Note: it is possible to supply the switch connected with the "European" bipolar plug with lengths and workings of the cables on customer request.*

*The standard lengths are:*

- 120 cm from the plug to the switch + 80 cm from the switch to the cable free-end.
- 100 cm from the plug to the switch + 50 cm from the switch to the cable free-end.

- Table of the available colours:

**T** = transparent

**B** = white

**N** = black

**O** = gold

- Other colours on request.

