

EDISON SCREW LAMPHOLDERS

P113M



Note 1: to tighten the clamps screws, use a screwdriver with a slot max diameter 3,5 mm.

Note 2: the lampholder P113M, in the cULus version, shall be connected with the following cables:

- flexible conductor with end-terminals length 6 mm,
- flexible conductor stripped 6 mm with tinning,
- solid conductor stripped 6 mm.

- Porcelain body in three parts with nipple, screw for nipple-block and device to avoid the un-screwing of the three parts, once assembled.
Nickel-plated brass contacts.
Central contact pressure spring in normalized stainless steel.
Brass clamps with slot screws.
Cap in zinc-plated or raw brass.

- Weight: 115 g.

- Fixing of the lampholder:
For versions P113- and P113T-, fixing by M10 x1 nipples.
For versions P114, fixing by M13 x1 nipples.
For versions P115, fixing by 3/8" nipples.

Lampholder:

E26

Maximum power:

660 W

Rated voltage:

250 V

Working temperature:

T 250°C

Type of clamps for

cables connection:

SCREW CLAMPS

Clamps connecting capacity:

18 AWG

In conformity to the standards:

UL 496

CSA 22.2 N.43

Approval marks:

cULus

Attention: connect the line cable, usually the black one, to the central contact clamp (L) and the neutral cable, usually the white one, to the lateral contact clamp (N).

Single-conductor connecting cables, polarized white and black, which could be connected to the lampholder (if flexible, arranged with crimped end-terminals l= 6 mm or stripped and tinned 6 mm; if solid, stripped 6 mm)

Insulation	T in °C	Conduct.	Available voltages and AWG		
			300V	600V	18AWG
Silicone <i>Single insulation</i>	200	CuSn		•	•
Silicone+glass-braid <i>Single insulation</i>	200	CuSn		•	•
FEP <i>Single insulation</i>	200	CuNi	•	•	•
FEP+FEP <i>Double insulation</i>	200	CuNi	•		•
PTFE <i>Single insulation</i>	250	CuNi	•	•	•
PTFE+PFA <i>Double insulation</i>	250	CuNi	•		•



P113-

P114

P115



Lampholder:

Rated voltage:
Rated current:
Working temperature:
Type of clamps for
cables connection:
Clamps connecting capacity:
Overvoltage category:
Protection degree (IP):
In conformity to the standards:
In conformity to the requirements
of the directive:

E27

250 V
4 A
T 220°C

SCREW CLAMPS
0,75 ÷ 1,00 mm²
III
IP20
EN 60838

2014/35/EU

Approval marks:

ENEC 10
CQC (only for the art. P113 and P113T)

P113: version with nipple M10 x1
without earth clamp.

P113T: version with nipple M10 x1
with earth clamp.

P114: version with nipple M13 x1
with earth clamp.

P115: version with nipple 3/8"
with earth clamp.

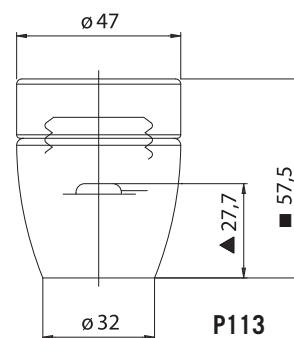
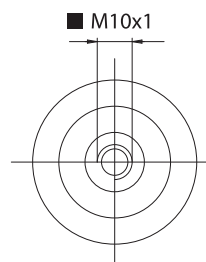

- For P113, nipple M10 x1, height 57,5 mm, and central contact distance 27,7 mm.
- For P113T nipple M10 x1, height 62,5 mm, and central contact distance 32,5 mm.
- For P114 nipple M13 x1, height 62,5 mm, and central contact distance 32,5 mm.
- For P115 nipple 3/8", height 62,5 mm, and central contact distance 32,5 mm.
- ▲ Central contact distance.

