

**P113-**

**P114**

**P115**



**Lampholder:**

Rated voltage:  
Rated current:  
Working temperature:  
Type of clamps for  
cables connection:  
Clamps connecting capacity:  
Overvoltage category:  
Protection degree (IP):  
In conformity to the standards:  
In conformity to the requirements  
of the directive:

**E27**

**250 V**  
**4 A**  
**T 220°C**

**SCREW CLAMPS**  
**0,75 ÷ 1,00 mm<sup>2</sup>**  
**III**  
**IP20**  
**EN 60838**

**2006/95/EC**

Approval marks:

**ENEC 10**  
**CQC** (only for the art. P113 and P113T)

**P113:** version with nipple M10 x1  
without earth clamp.

**P113T:** version with nipple M10 x1  
with earth clamp.

**P114:** version with nipple M13 x1  
with earth clamp.

**P115:** version with nipple 3/8"  
with earth clamp.

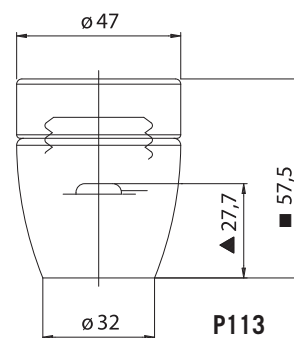
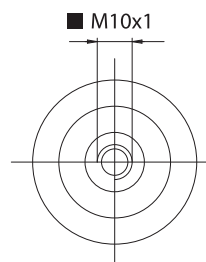

- For P113, nipple M10 x1, height 57,5 mm, and central contact distance 27,7 mm.
- For P113T nipple M10 x1, height 62,5 mm, and central contact distance 32,5 mm.
- For P114 nipple M13 x1, height 62,5 mm, and central contact distance 32,5 mm.
- For P115 nipple 3/8", height 62,5 mm, and central contact distance 32,5 mm.
- ▲ Central contact distance.



# EDISON SCREW LAMPHOLDERS

## P113M



Note 1: to tighten the clamps screws, use a screwdriver with a slot max diameter 3,5 mm.

Note 2: the lampholder P113M, in the cULus version, shall be connected with the following cables:

- flexible conductor with end-terminals length 6 mm,
- flexible conductor stripped 6 mm with tinning,
- solid conductor stripped 6 mm.

- Porcelain body in three parts with nipple, screw for nipple-block and device to avoid the un-screwing of the three parts, once assembled.  
Nickel-plated brass contacts.  
Central contact pressure spring in normalized stainless steel.  
Brass clamps with slot screws.  
Cap in zinc-plated or raw brass.

- Weight: 115 g.

- Fixing of the lampholder:  
For versions P113- and P113T-, fixing by M10 x1 nipples.  
For versions P114, fixing by M13 x1 nipples.  
For versions P115, fixing by 3/8" nipples.

### Lampholder:

**E26**

Maximum power:

**660 W**

Rated voltage:

**250 V**

Working temperature:

**T 250°C**

Type of clamps for

cables connection:

**SCREW CLAMPS**

Clamps connecting capacity:

**18 AWG**

In conformity to the standards:

**UL 496**

**CSA 22.2 N.43**

Approval marks:

**cULus**

Attention: connect the line cable, usually the black one, to the central contact clamp (L) and the neutral cable, usually the white one, to the lateral contact clamp (N).

Single-conductor connecting cables, polarized white and black, which could be connected to the lampholder (if flexible, arranged with crimped end-terminals l= 6 mm or stripped and tinned 6 mm; if solid, stripped 6 mm)

Insulation	T in °C	Conduct.	Available voltages and AWG		
			300V	600V	18AWG
Silicone <i>Single insulation</i>	200	CuSn		•	•
Silicone+glass-braid <i>Single insulation</i>	200	CuSn		•	•
FEP <i>Single insulation</i>	200	CuNi	•	•	•
FEP+FEP <i>Double insulation</i>	200	CuNi	•		•
PTFE <i>Single insulation</i>	250	CuNi	•	•	•
PTFE+PFA <i>Double insulation</i>	250	CuNi	•		•

