

# FOR NET TENSION 110 - 250V

## P35

CE

### Lampholder:

Rated voltage:  
Rated current:  
Working temperature:  
Type of clamps to connect the cables:  
Connecting capacity of the clamps:  
Overvoltage category:  
Protection degree (IP):  
In conformity to the standards:  
In conformity to the requirements of the directive:

Gx16d

250 V  
10 A  
T 250°C

SCREW CLAMPS

0,75 ÷ 2,5 mm<sup>2</sup>  
III  
IP20  
EN 60838-1

2014/35/EU

Approval marks:

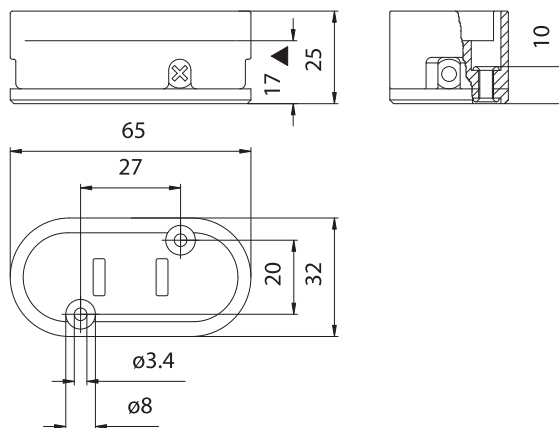

▲ Reference plane



# LAMPHOLDERS FOR INCANDESCENT HALOGEN LAMPS

- Porcelain body.  
Contacts in nickel-plated brass.  
Nickel-plated brass clamps with screws not completely tightened.
- Weight of the lampholder: 75 g.

- Instructions to fix the lampholder on structures.

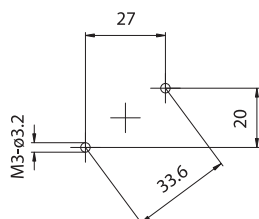

- Eventual fixing of the lampholder using holes diameter 3,4 mm.  
center distance 33,6 mm.

