

SINGLE-CONDUCTOR CABLES INSULATED IN PVC

T105°C cURus



Type of insulation: PVC

Working temperature: T 105°C - STYLE 1569
T 80°C - STYLE 1007

Type of conductor: TIN-PLATED COPPER

Working voltage: 300 V

In conformity to the standards: UL 758/1581 CSA C22.2 n. 210.5
AWM STYLE 1569 + AWM STYLE 1007

Approval marks: cURus



PROCESSED WIRE FILE E221012

RESPOOLED WIRE FILE E221012

- AWG table of the flexible conductor:

Code	AWG	Conductor strand	External diameter ±0,2 mm
WA1S-	26 AWG	8 x 0,150	1,45
WA1C-	24 AWG	7 x 0,193	1,55
WA19-	22 AWG	12 x 0,193	1,70
WA13-	20 AWG	19 x 0,193	1,90
WA18-	18 AWG	28 x 0,193	2,10

- Other AWG on request.

- AWG table of the solid conductor:

Code	AWG	Conductor strand	External diameter ±0,2 mm
WAR3-	20 AWG	1 x 0,85	1,80
WAR8-	18 AWG	1 x 1,05	1,95

- Other AWG on request.

- cURus approval printing on the sheath.

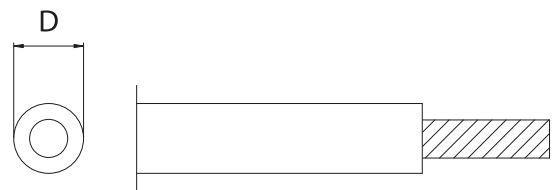

- Table of available colours:

B = white
N = black
G = yellow/green (ground cable)
- Other colours on request.

Note: this kind of cables may be supplied in spools, rolls or cut and processed according to customer's request (for cable workings and terminals see "Section 8").